

## Know your Table Top Can Opener

Your Kenwood Can Opener can be used to open a variety of domestic can shapes and sizes. In addition the CO600 Series incorporates a bottle opener and a knife sharpening facility.

### IMPORTANT SAFEGUARDS

When using electrical appliances basic safety precautions should always be followed, including the following:-

1. Read all instructions.
2. This appliance is not intended for use by young children or infirm persons without supervision.
3. Do not immerse appliance, cord or plug in water or other liquid.
4. Do not use the appliance if it is damaged.
5. Unplug the appliance from the mains supply
  - before cleaning
  - immediately after use
6. Do not use the appliance for other than its intended use.
7. This appliance is for domestic use only.
8. Young children should be supervised to ensure that they do not play with this appliance.

### KEEP THESE INSTRUCTIONS

#### Connecting to Power

Before switching on make sure that the voltage of your electricity supply is the same as that indicated on the underside of your can opener.

**IMPORTANT (UK ONLY):** The wires in the mains lead are coloured in accordance with the following code:

BLUE	NEUTRAL
BROWN	LIVE

#### NOTE:

This can opener complies with European Economic Community Radio Interference Directive 89/336/EEC.

## Key

- |                  |                    |
|------------------|--------------------|
| 1. Bottle Opener | 5. Cutter Blade    |
| 2. Drive Wheel   | 6. Guide Pin       |
| 3. Magnet        | 7. Knife Sharpener |
| 4. Lever         | 8. Cord Stowage    |

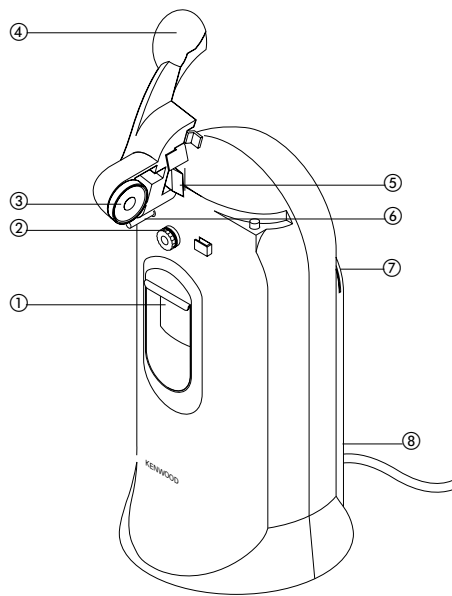

## Using your Table Top Can Opener

1. Plug the appliance into the power supply.
2. Lift the lever to the open position.
3. Hold the can with the top rim resting under the metal guide pin and the can resting on the drive wheel (Fig. 1).
4. Press the lever lightly down to start the motor. The self-starting blade will then pierce the can and commence cutting (Fig. 2).
5. The can will be held fixed in position with the magnet resting against the lid. Large or wide cans may require extra support from the user.
6. Once the can is open, the motor will automatically stop, retaining the can and lid safely in place.
7. To remove, lift the lever whilst holding the can.
8. With the exception of aluminium cans, the lid will be retained by the magnet (Fig. 3).
9. For tidiness, any unwanted length of cord can be stowed inside the appliance.
10. Do not use the appliance to open ring-pull cans.

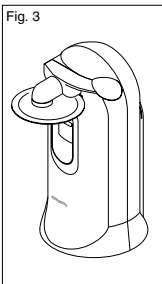
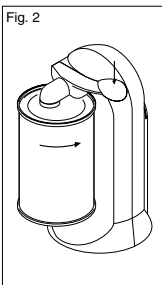
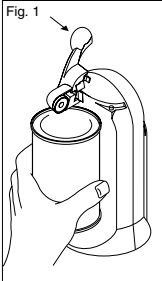

### Using the Bottle Opener

When opening tall bottles, the unit should be used towards the edge of a work top.

1. Position the bottle with the cap under the front rim of the bottle opener.
2. Push down the bottle to remove the cap whilst steadying the unit with one hand.

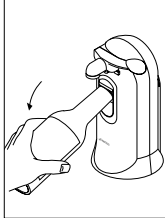

### Using the Knife Sharpener

1. With the can opener sideways on, place the knife into one of the recesses.
2. Gradually draw it towards yourself. Then place the knife in the other recess and repeat. Take care not to allow the knife to cut into the body of the can opener.
3. Repeat this cycle several times in order to sharpen the knife satisfactorily.

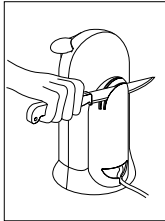

**NOTE:** Knives without a serrated edge, preferably carbon steel are most suitable for sharpening.

### Cleaning

1. Disconnect the appliance by switching off and removing the plug from the power supply.
2. Lift the lever fully and withdraw the assembly from the can opener.
3. Wash the lever in hot sudsy water and dry thoroughly. Dishwasher is not advised.
4. Replace the lever in the body
5. Wipe over the body with a damp cloth and dry thoroughly.

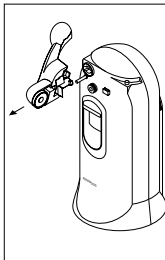

### Service

If the cord of this appliance is damaged it must, for safety reasons, be replaced by Kenwood or an authorised Kenwood repairer.

#### UK

If you need help with:

using your can opener or servicing or repairs (in or out of guarantee) call Kenwood on **023 9239 2333**. Have your model number ready, it is on the underside of your can opener.

#### EIRE

Contact local repairer from advertisement in **GOLDEN PAGES**.

#### ALL OTHER MARKETS

Contact the dealer from whom you purchased your appliance.

# KENWOOD

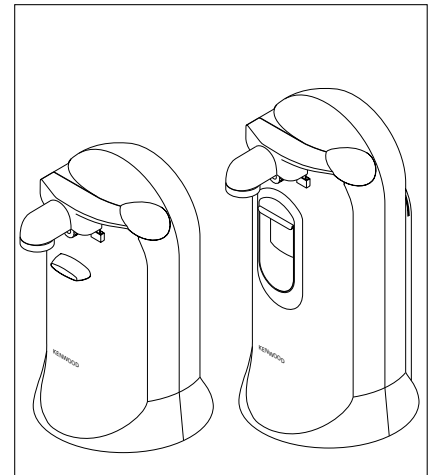

CO600 series

**KENWOOD** LIMITED

New Lane • Havant • Hants • PO9 2NH  
www.kenwood.co.uk

10203/2